

# Rosses Point Public Realm Enhancement Project

## Background

Sligo County Council secured RRDF funding to prepare the first stage of a new public realm scheme for the villages of Rosses Point and Strandhill.

### The Aims of the Rural Regeneration and Development Fund (RRDF)

- Rejuvenate towns and villages
- Support people to live, work and learn in their own community
- Enhance our unique outdoor amenities, culture and heritage
- Strengthen rural economies and achieve economic and social development in these areas
- Re-purpose derelict, disused or heritage buildings
- Deliver tourism infrastructure

### The Overarching Vision

- To support the function of Strandhill and Rosses Point as effective suburbs of Sligo town and to enable them to grow in a sustainable and safe manner into the future.
- To enhance the tourism potential and capacity of these settlements.
- To readdress the balance between pedestrian and vehicular activity to improve safety and the overall visitor experience of these settlements.

### Have Your Say

The following pages highlight options and opportunities for Rosses Point, we would appreciate any feedback you may have.

[Tell us your thoughts - Click on 'make a submission' answer our questions and let us know what you think.](#)

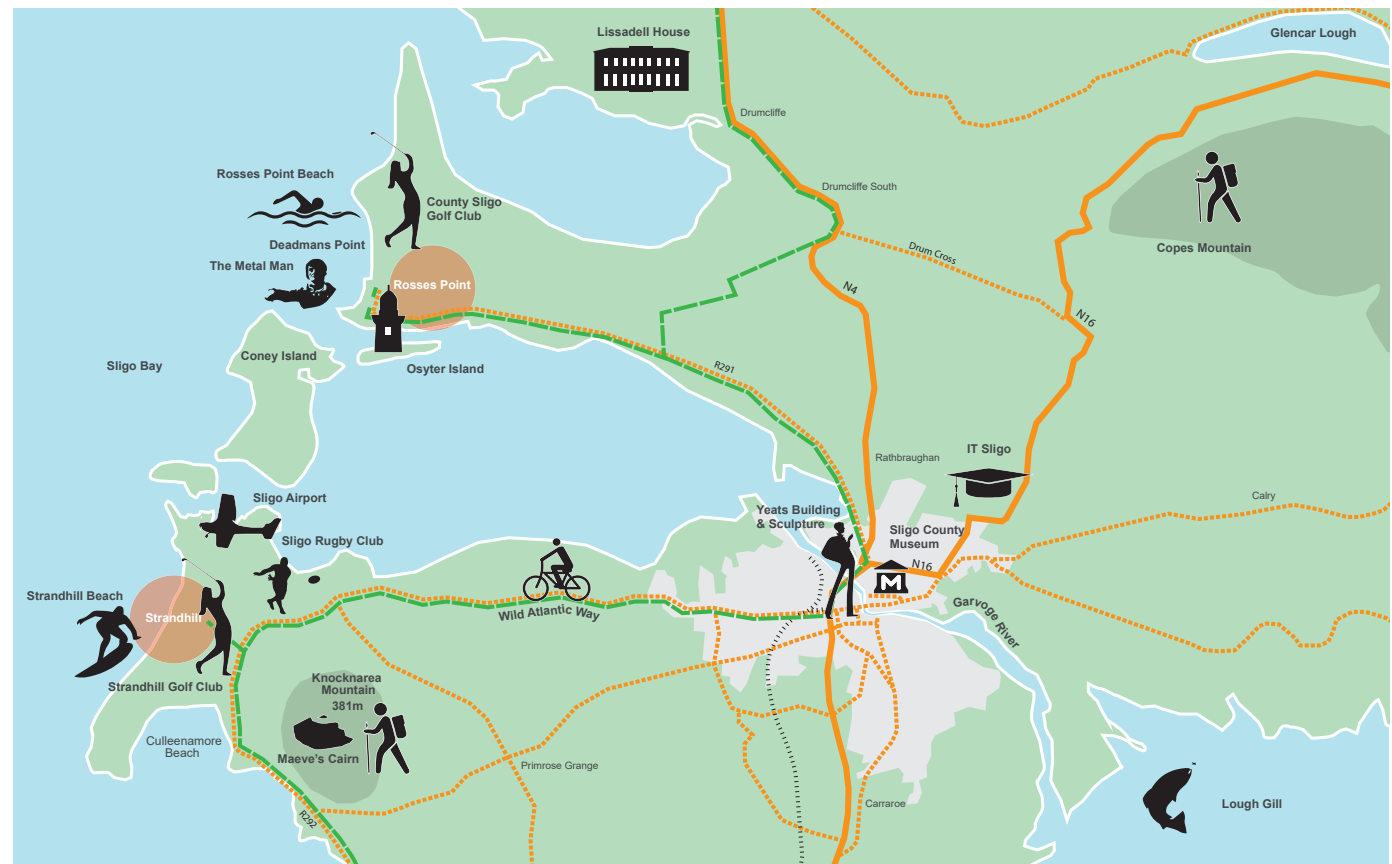

	Wild Atlantic Way		Sligo Town Centre
	Main Vehicular Transport Routes		Project Site Location
	Secondary Transport Routes		Local Destinations / Attractions
	Railway Network		



# Rosses Point Public Realm Enhancement Project

## Introduction



Key images depicting the local landscape character at Rosses Point



## Aim

“To create a **safe, friendly and well-connected** village core with exciting, vibrant and innovative **public realm enhancements**, enhancing links to the beach whilst protecting the **valuable and unique** environment of Rosses Point.”



This project is being funded by the Department of Rural and Community Development through the Rural Regeneration and Development Fund.

October 2021

# Rosses Point Public Realm Enhancement Project

## Existing Key Issues



View looking along the Old Road

- No footpaths creating pedestrian safety issues
- No designated crossing points
- Excessive traffic and parking create an unsafe environment for pedestrians especially children and other vulnerable road users
- Lack of connection with promenade and seafront
- Speed of traffic along the Old Road
- Lack of seating and signage infrastructure



View looking along the New Road

- Lack of designated crossing points along the New Road
- Speed of traffic along the New Road
- Lack of pedestrian connections to the Old Road
- Lack of well integrated cycle infrastructure
- Lack of seating and signage infrastructure

# Rosses Point Public Realm Enhancement Project

## Key Objectives



1. Ensure pedestrian safety

2. Strengthen connectivity for pedestrians and cyclists



3. Reduce traffic speeds

4. Enhance the character, views and heritage



5. Create a destination at the heart of the village

6. Reconfigure parking





# Rosses Point Public Realm Enhancement Project

## A Vision for Rosses Point - Overall Concept Masterplan



# Rosses Point Public Realm Enhancement Project

## A Vision for Rosses Point - Key Precedents

Reconfigured Parking



Cycleway Improvements



Street Furniture Improvements



Improved Pedestrian Crossing Points



Village Road Improvements



New Gateway Features



# Rosses Point Public Realm Enhancement Project

## The Old Village Road - Concept Design Options

This particular RRDF funded project will focus on the Old Village Road and the New Road.

We have come up with a few options as to how we think we could address the issues you raised in relation to the Old Village Road.

We have used a sample of Old Village Road opposite the Driftwood to help us illustrate our plans for each option. [Have a look and tell us what you think?](#)

### Concept Design Option 1

#### One-way system with generous footpath on the northern side

We think a one-way system has the potential to reduce traffic on this road and allow us to create a pedestrian priority zone and an attractive space that is safe for all users.

#### Typical Design Principles include:

- One-way access
- Generous footpath on residential side of the road
- On street parking
- Accesses to garages and buildings would be maintained

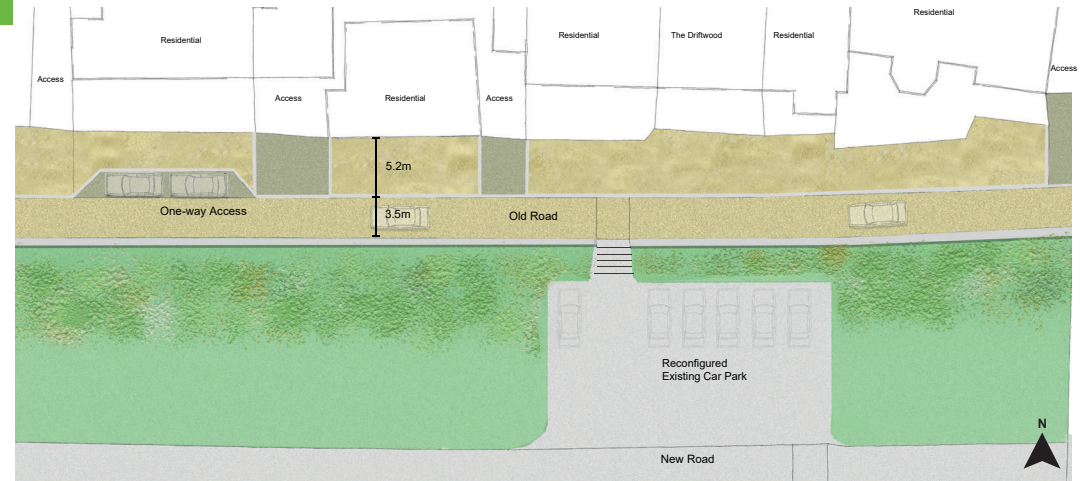

### Concept Design Option 2

#### Two-way system with footway on promenade side

This option involves retaining two way traffic, building a footpath on one side of the road as well as measures to slow down the speed of traffic, thus improving pedestrian safety.

#### Typical Design Principles

- Existing two-way access maintained with new footpath to the promenade side.
- On-street parking would be marked on the carriageway
- 'Build outs' at key locations to help manage the speed of traffic
- Accesses to garages and buildings would be maintained

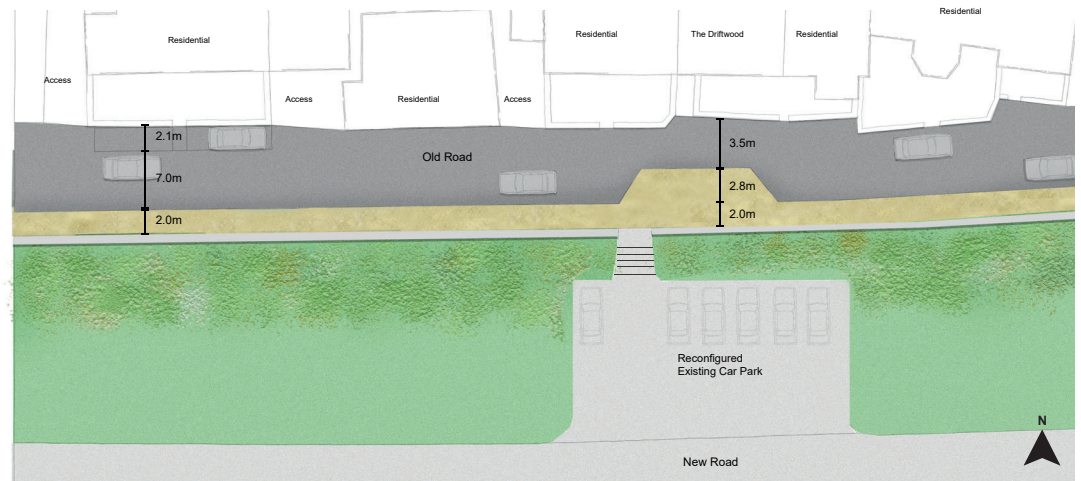

October 2021

# Rosses Point Public Realm Enhancement Project

## The Old Village Road illustrating the potential of a one-way system



Artistic impression of how the Old Road could look with a one-way traffic system and wide pedestrian footpaths



This project is being funded by the Department of Rural and Community Development through the Rural Regeneration and Development Fund.

October 2021