

**CONCRETE PATH AND KERB**  
(FINISH TO ARCHITECT'S SPEC.)

**NOTE**  
RADIUS KERBS AS REQUIRED.  
DROP KERBS AS REQUIRED.

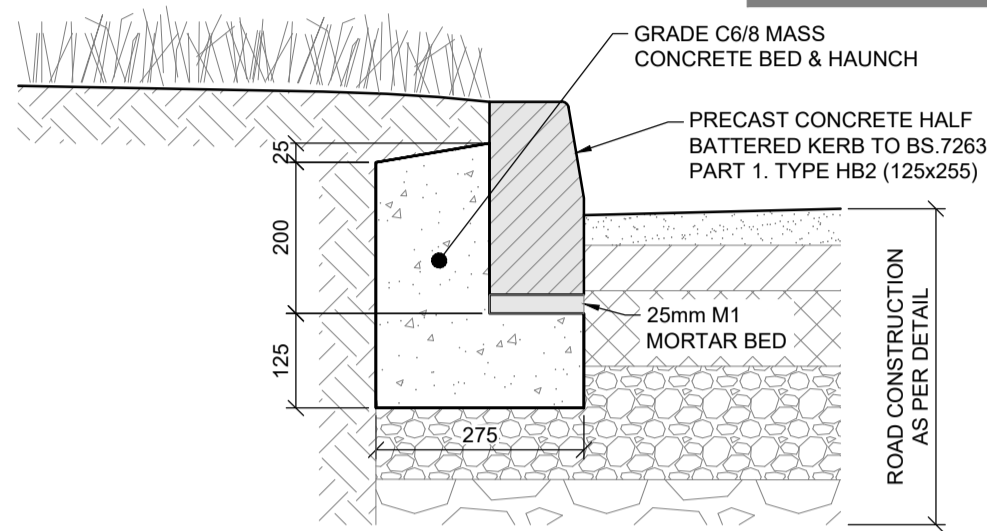

**ROAD AND GRASS**  
(FINISH TO ARCHITECT'S SPEC.)

**TYPICAL HALF BATTERED KERB DETAIL**

SCALE: 1:10

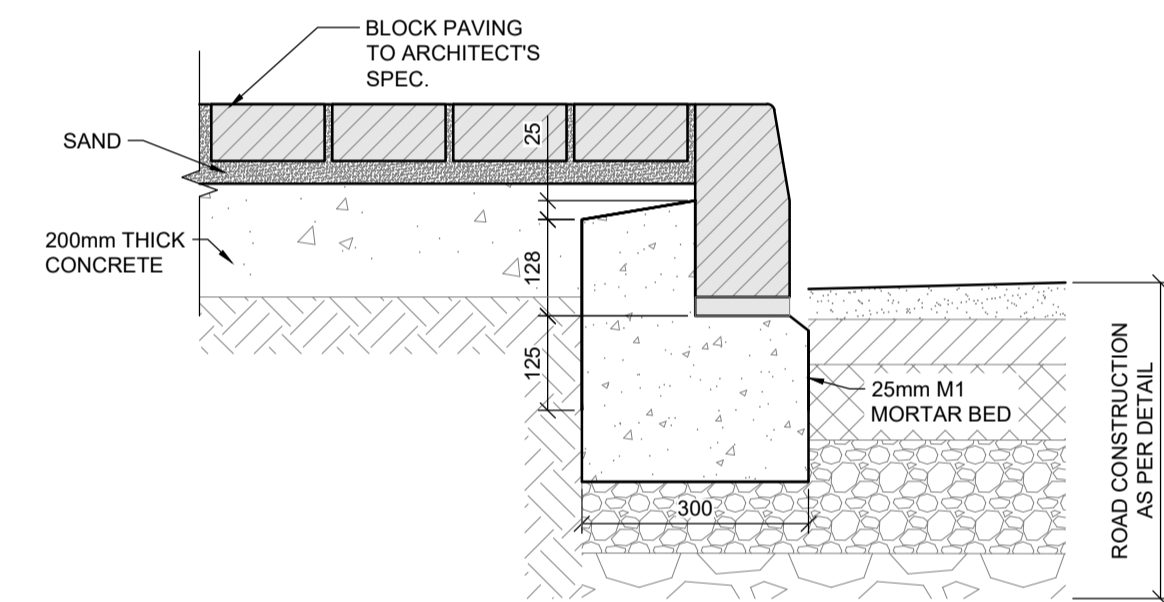

**BLOCK PAVING & KERB**  
(FINISH TO ARCHITECT'S SPEC.)

**DETAIL OF BLOCK PAVING**

SCALE: 1:10

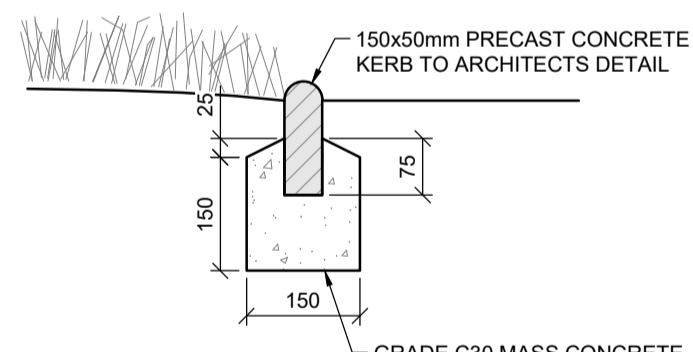

**TYPICAL FLUSH P.C. KERB DETAIL**

SCALE: 1:10

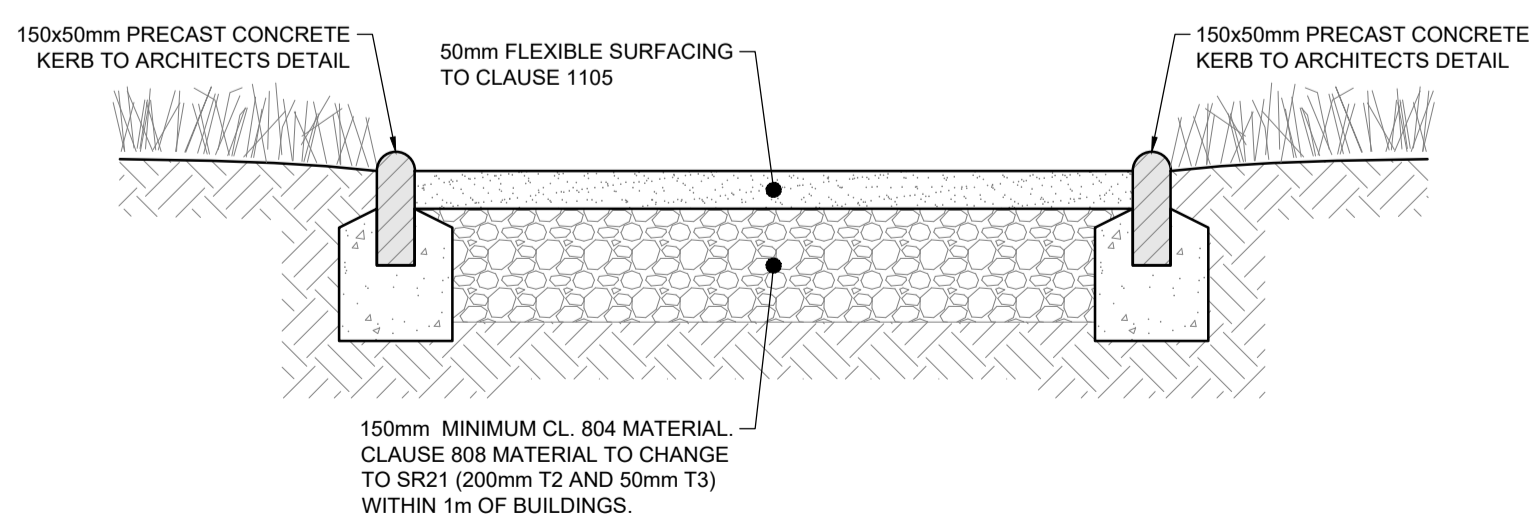

**TYPICAL FLEXIBLE FOOTPATH BUILD UP DETAIL**

SCALE: 1:10

FOOTPATH CONSTRUCTION T.B.C.

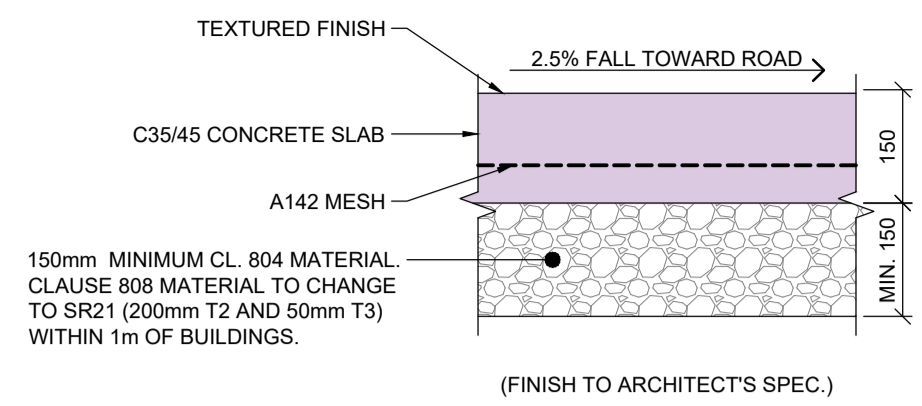

**NOTES**  
1. FOOTPATH TO FALL @ 1:40 AWAY FROM BUILDING AS A MINIMUM BUT MAY BE INCREASED BY ARCHITECT.  
2. PROVIDE CONTRACTION JOINTS @ 3m C/C.

**PROPOSED CONCRETE FOOTPATH BUILD UP DETAIL**

SCALE: 1:10

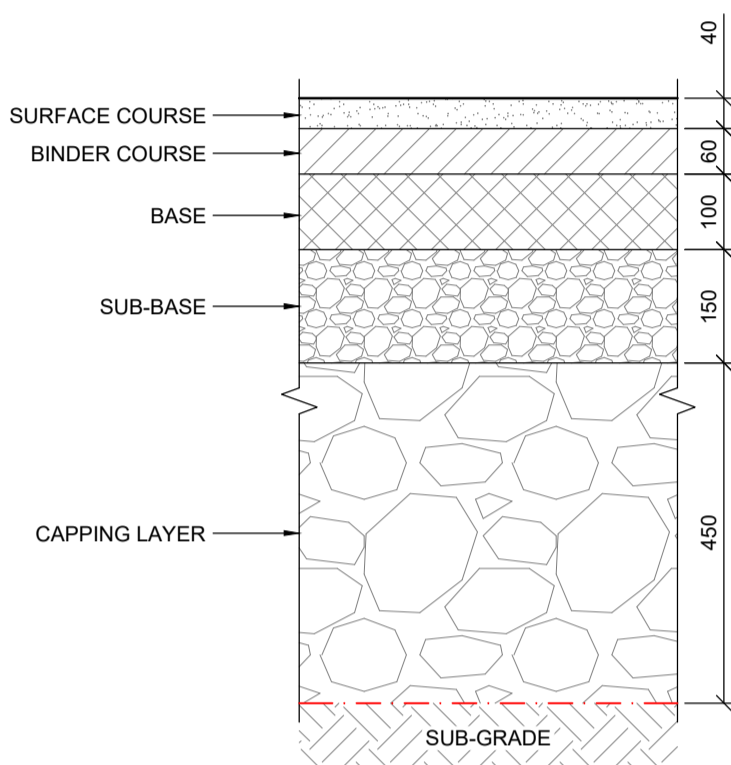

SURFACING TYPE / ROAD BUILD UP			
LAYER	THICKNESS	MATERIAL	BINDER (PENETRATION GRADE MACADAM)
SURFACE COURSE	40mm	AC 14 CLOSE SURFACE	PMB 65 / 105-60 des
BINDER COURSE	60mm	AC 20 DENSE BIN	70/100 REC
BASE	100mm	AC 32 DENSE BASE	70/100 REC
SUB-BASE	150mm	CLAUSE 804	
CAPPING	450mm	6F2	

• PSV OF SURFACE COURSE > 60.  
• AAV ≤ 16  
• HORIZONTAL JOINTS BETWEEN SURFACING LAYERS TO RECEIVE A POLYMER MODIFIED BOND COAT IN ACCORDANCE WITH BS 594987 AND CL 900 OF TII SPECIFICATION FOR ROADWORKS.

**PROPOSED CARRIAGEWAY BUILD UP DETAIL**

SCALE: 1:10

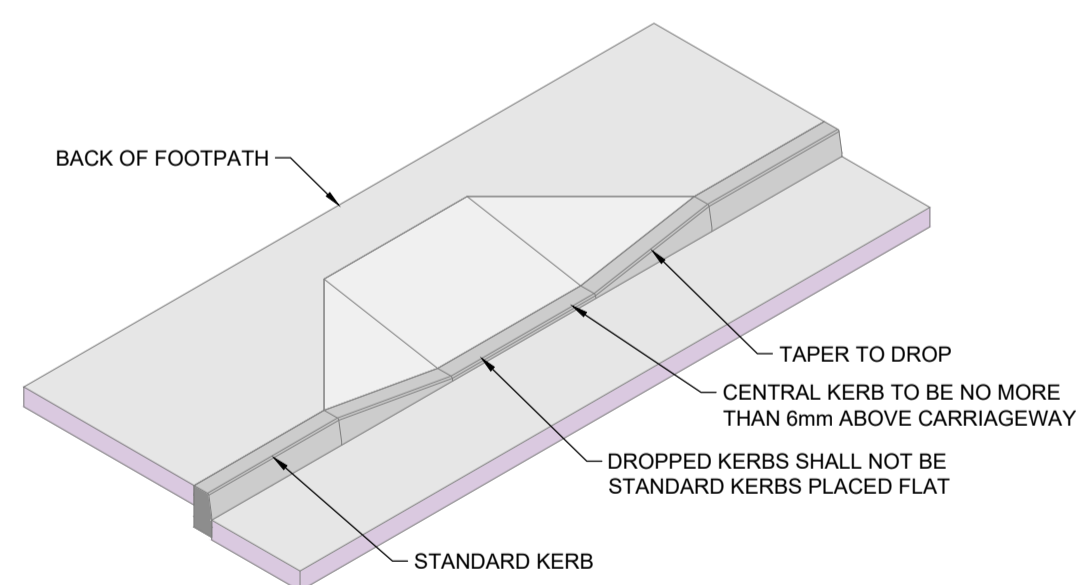

**TYPICAL DROPPED KERB DETAIL**

SCALE: 1:10

**NOTE**  
REFER TO ARCHITECT'S DRAWING FOR LINE OF KERBING, LOCATIONS OF TACTILE PAVING, DROPPED KERBS, RAMPS, FOOTPATHS, ETC.

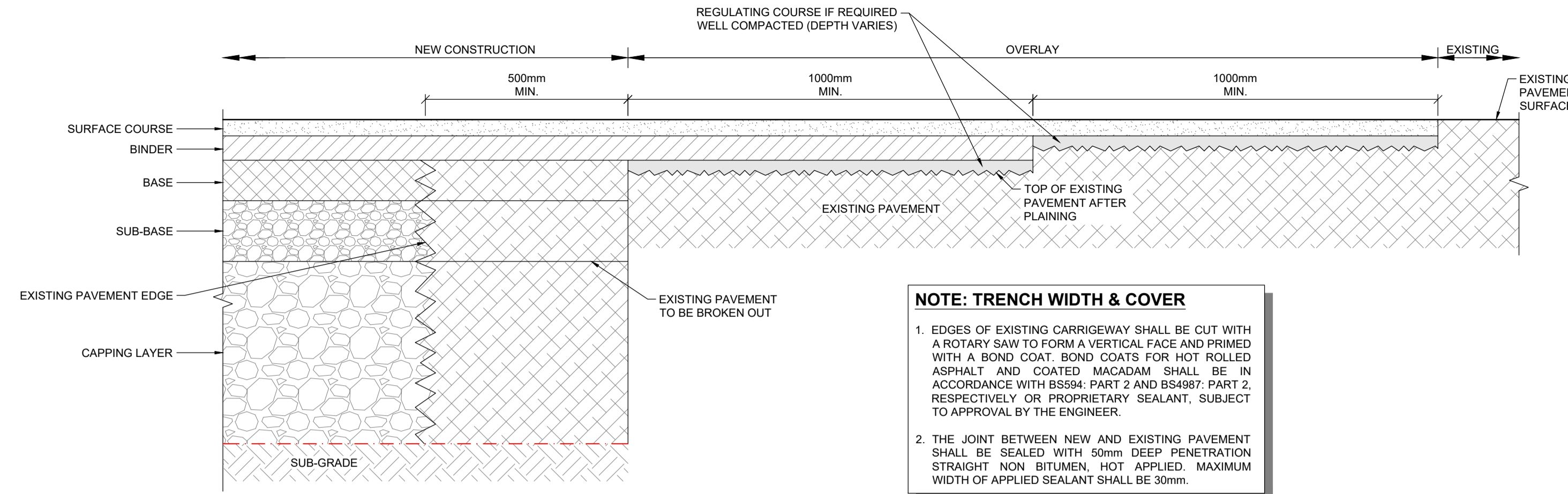

**TRANSVERSE JOINT BETWEEN NEW CONSTRUCTION AND EXISTING ROAD**

SCALE: 1:10

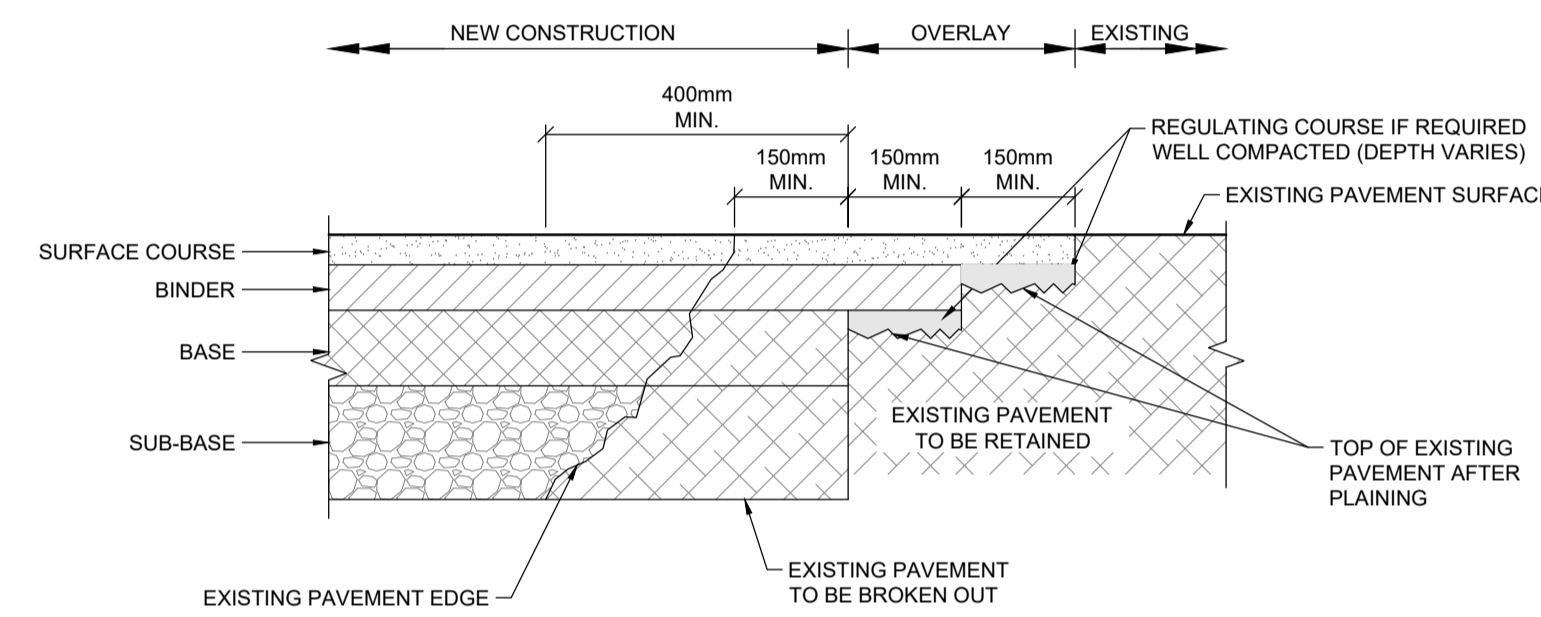

**LONGITUDINAL JOINT BETWEEN NEW CONSTRUCTION AND EXISTING ROAD**

SCALE: 1:10

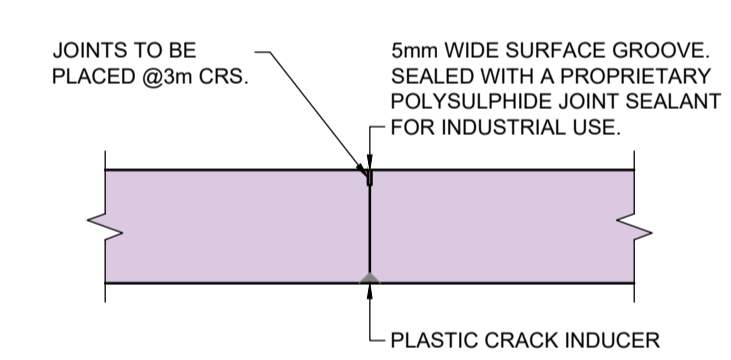

**TYPICAL INDUCED CONTRACTION JOINT DETAIL (FOOTPATH)**

SCALE: 1:10

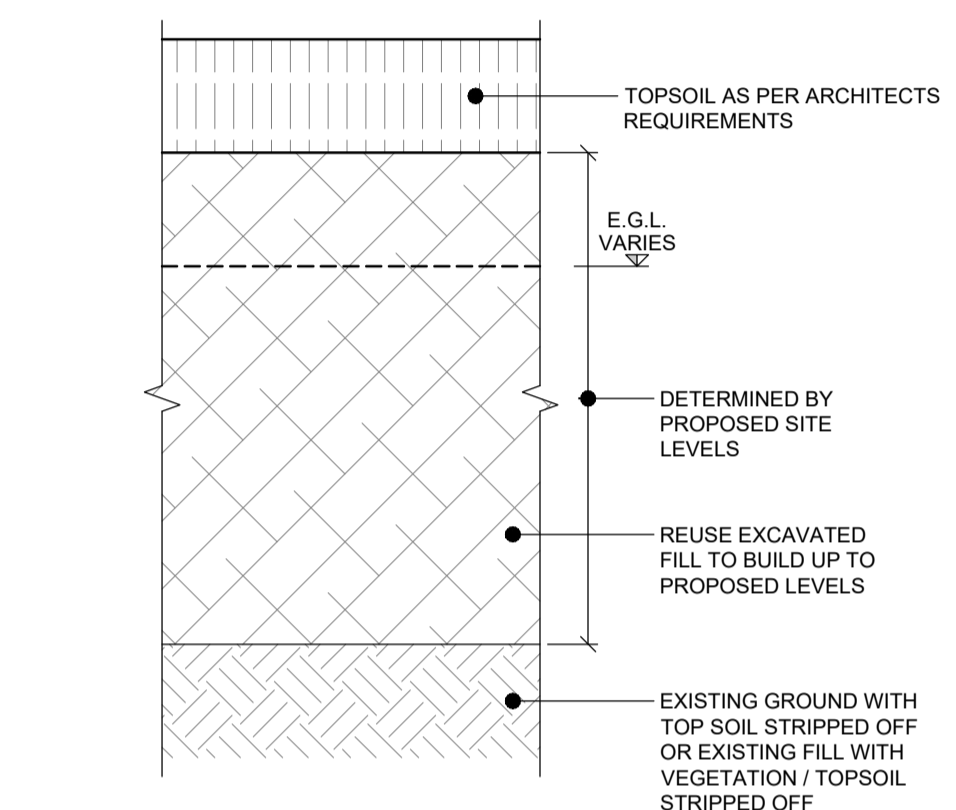

**PROPOSED GREEN AREA (INCL. GARDENS) BUILD UP DETAIL**

SCALE: 1:10

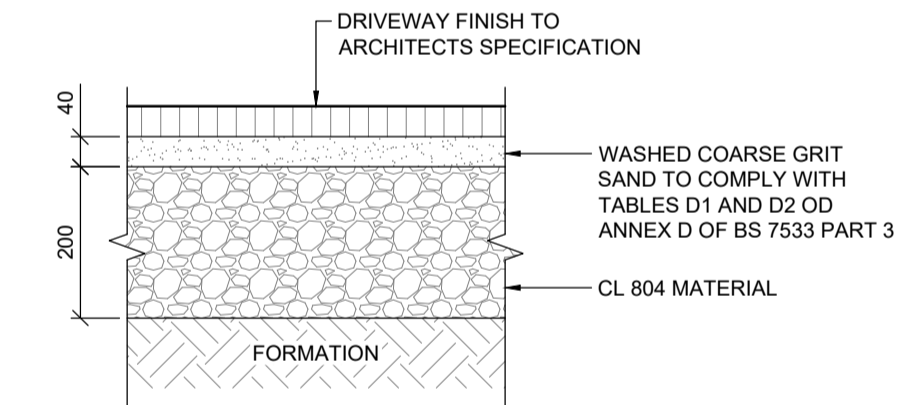

**PROPOSED DRIVEWAY BUILD UP DETAIL**

SCALE: 1:10

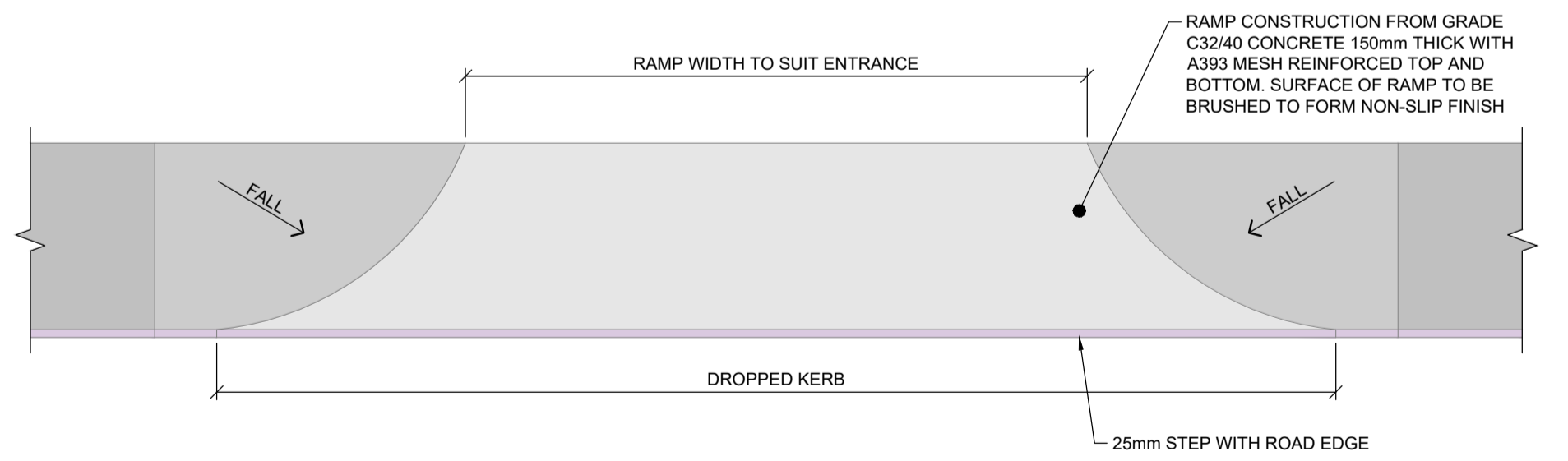

**TYPICAL RAMP DETAIL**

SCALE: 1:10

DO NOT SCALE FROM THIS DRAWING. USE FIGURED DIMENSIONS IN ALL CASES. VERIFY DIMENSIONS ON SITE AND REPORT ANY DISCREPANCIES TO THE DESIGNERS IMMEDIATELY. THIS DRAWING IS COPYRIGHT AND MAY ONLY BE REPRODUCED WITH THE DESIGNERS PERMISSION.

- NOTES:**
- ALL DRAWINGS ARE TO BE READ IN CONJUNCTION WITH ALL RELEVANT SPECIFICATIONS, BILLS OF QUANTITIES, ARCHITECTURAL, SERVICES AND ENGINEERING DRAWINGS.
  - ALL LEVELS ARE IN METRES RELATED TO ORDNANCE DATUM MALIN HEAD.
  - ANY DISCREPANCIES BETWEEN THESE DOCUMENTS SHALL BE BROUGHT TO THE ATTENTION OF THE ENGINEER.
  - DRAWINGS ARE NOT TO BE SCALED.
  - ALL DIMENSIONS ARE IN MILLIMETRES, UNLESS NOTED OTHERWISE.

REV	DATE	ISSUED FOR INFORMATION	PK	BS
R01	12/04/2021	ISSUED FOR INFORMATION		

PROJECT: CONNOLLY PARK, TUBBERCURRY CO. SLIGO

TITLE: SITE PAVEMENT DETAILS

CLIENT: SLIGO COUNTY COUNCIL

**Malachy Walsh and Partners**  
Engineering and Environmental Consultants  
Cork | Tralee | London | Limerick

The Elm Suite, Loughmore Centre, Raheen Business Park, Limerick, V94 R578  
Tel: +353 (0) 61 480164  
Fax: +353 (0) 61 441125  
E-mail: limerick@mwp.ie  
Web: www.mwp.ie

DRAWN: P.K.	CHECKED: M.O.D.	APPROVED: B.S.
DATE: Not Issued	SCALE @ A1: AS SHOWN	
PROJECT NUMBER: 19835	DRAWING STATUS: A	

DRAWING NUMBER: SCC01-MWP-00-00-DR-C-0400 REV: P01