

Rosses Point Public Realm Enhancement Project

Background

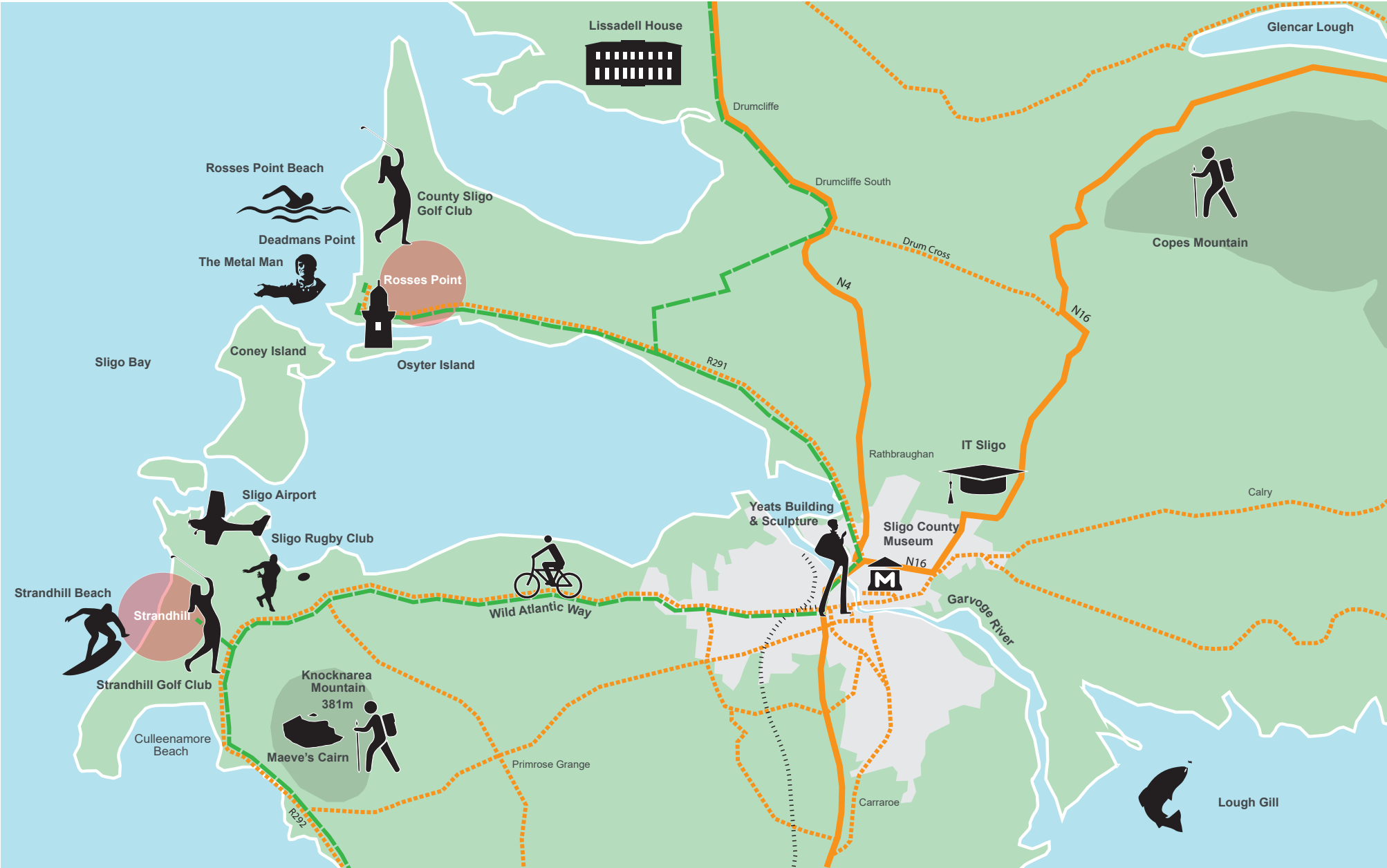

Sligo County Council secured RRDF funding to prepare the first stage of a new public realm and traffic management enhancement scheme for Rosses Point

Wild Atlantic Way

Main Vehicular Transport Routes

Secondary Transport Routes

Railway Network

Sligo Town Centre

Project Site Location

Local Destinations / Attractions

The Aims of the Rural Regeneration and Development Fund (RRDF)

- Rejuvenate towns and villages
- Support people to live, work and learn in their own community
- Enhance our unique outdoor amenities, culture and heritage
- Strengthen rural economies and achieve economic and social development in these areas
- Re-purpose derelict, disused or heritage buildings
- Deliver tourism infrastructure

The Overarching Vision

- To support the residential function of Rosses Point and to enable the village to grow in a sustainable and safe manner into the future.
- To enhance the tourism potential and capacity of the village.
- To readdress the balance between pedestrian and vehicular activity to improve safety and the experience for visitors and locals alike.

Have Your Say

The following pages showcase our thoughts on how to address the issues you raised regarding Rosses Point

[Click on ‘make a submission’ and let us know what you think.](#)

Rosses Point Public Realm Enhancement Project

Introduction



Aim

“To create a **safe, friendly and well-connected** village core with exciting, vibrant and innovative **public realm enhancements**, enhancing links to the beach whilst protecting the **valuable and unique** environment of Rosses Point.”

Existing Key Issues



View looking along the Old Road



View looking along the New Road

- No footpaths creating pedestrian safety issues
- No designated crossing points
- Excessive traffic and parking create an unsafe environment for pedestrians especially children and other vulnerable road users
- Lack of connection with promenade and seafront
- Speed of traffic along the Old Road
- Lack of seating and signage infrastructure
- Lack of designated crossing points along the New Road
- Speed of traffic along the New Road
- Lack of pedestrian connections to the Old Road
- Lack of well integrated cycle infrastructure



Rosses Point Public Realm Enhancement Project

What were the key points raised in the consultation so far?

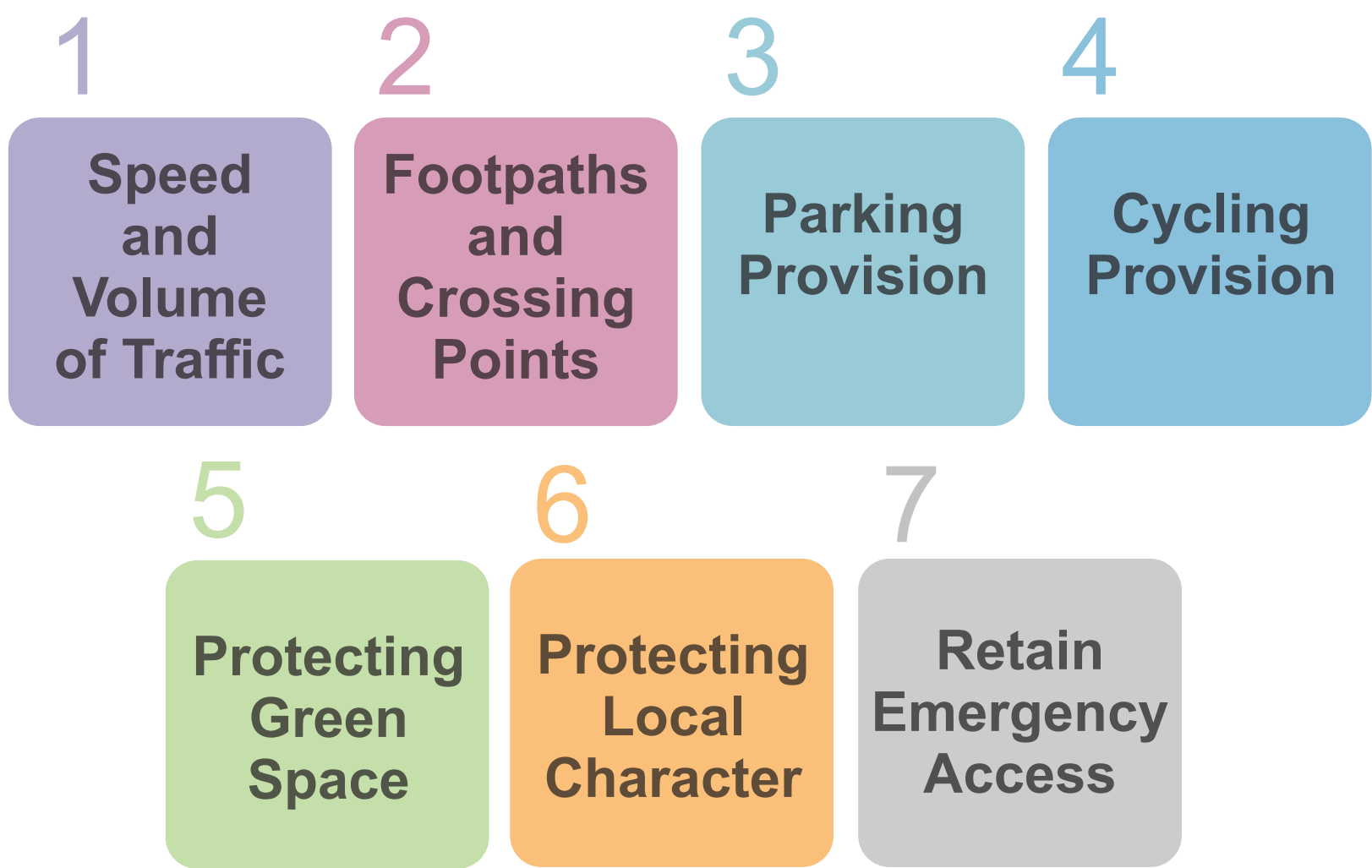

Proposed areas of improvements

Based on the key issues raised in the consultations held to date, we propose to focus on the following areas.



Key - Proposals

- Junction improvement works, including new crossing points and traffic calming
- Additional traffic calming/ crossing points installed at key nodal locations
- Reconfigured and enhanced parking areas
- New two-way cycleway integrated at footway level along the promenade side of the carriageway.
- 1 - entrance to the old village road at the Sligo Golf Club
- 2 - outside Austies
- 3 - outside Driftwood
- 4 - outside Harry's Bar
- 5 - junction at the Little Cottage Cafe and Bay View Stores
- 6 - start of the promenade / entrance to the village



Rosses Point Public Realm Enhancement Project

Areas of improvements

1. Junction at the Sligo Golf Club



The aim of this intervention is to divert traffic away from the old village road and make it safer for pedestrians

2. Area outside Austies



The aim of this intervention is to improve pedestrian safety outside Austies, slow down traffic on the main road and improve the connections between key facilities and the sea promenade.

Rosses Point Public Realm Enhancement Project

3. Area outside Driftwood

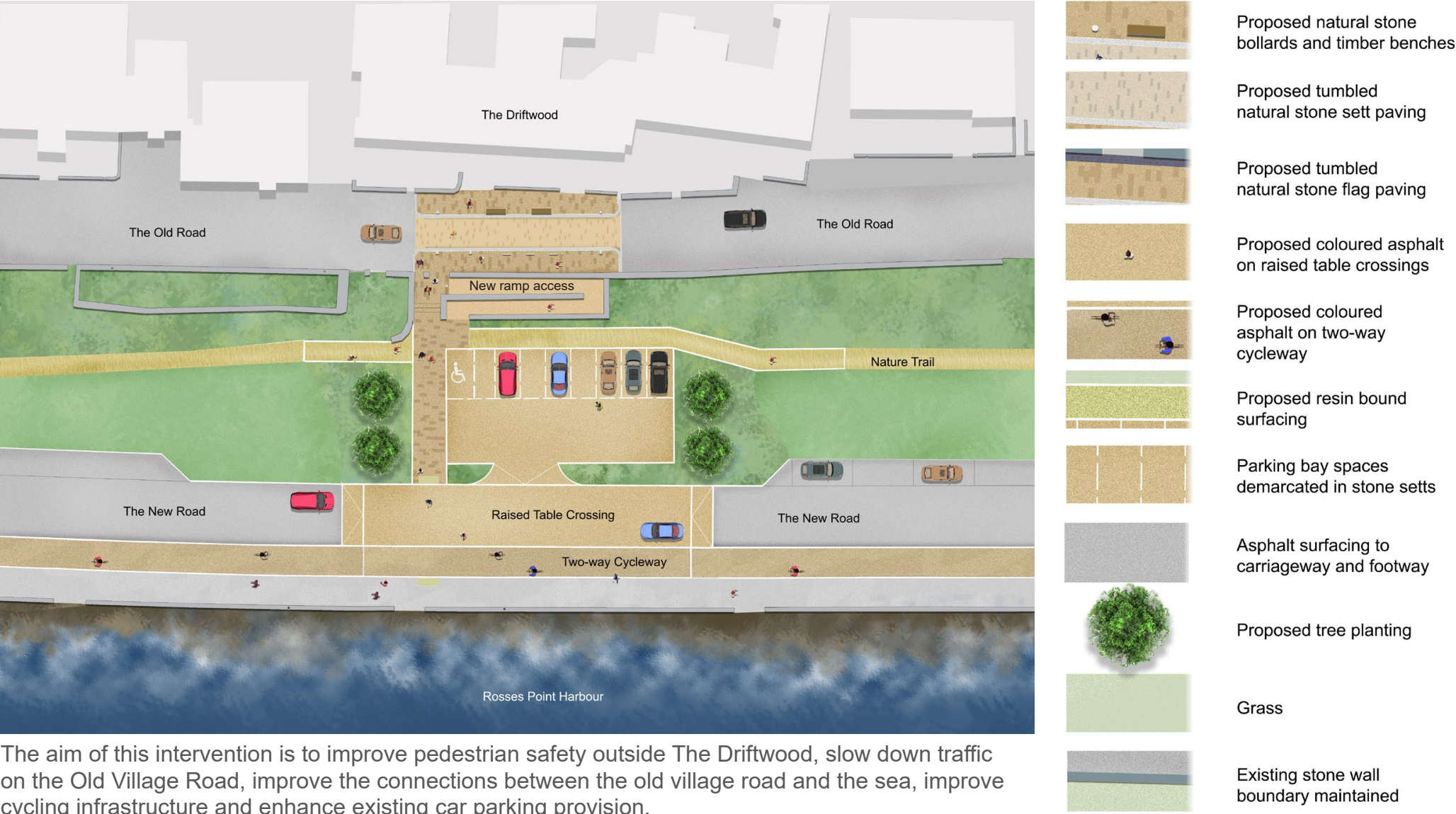

3. Area outside Harry's



This project is being funded by the Department of Rural and Community Development through the Rural Regeneration and Development Fund.

Rosses Point Public Realm Enhancement Project

Areas of improvements

5. Junction at the Little Cottage Cafe and Bay View Stores

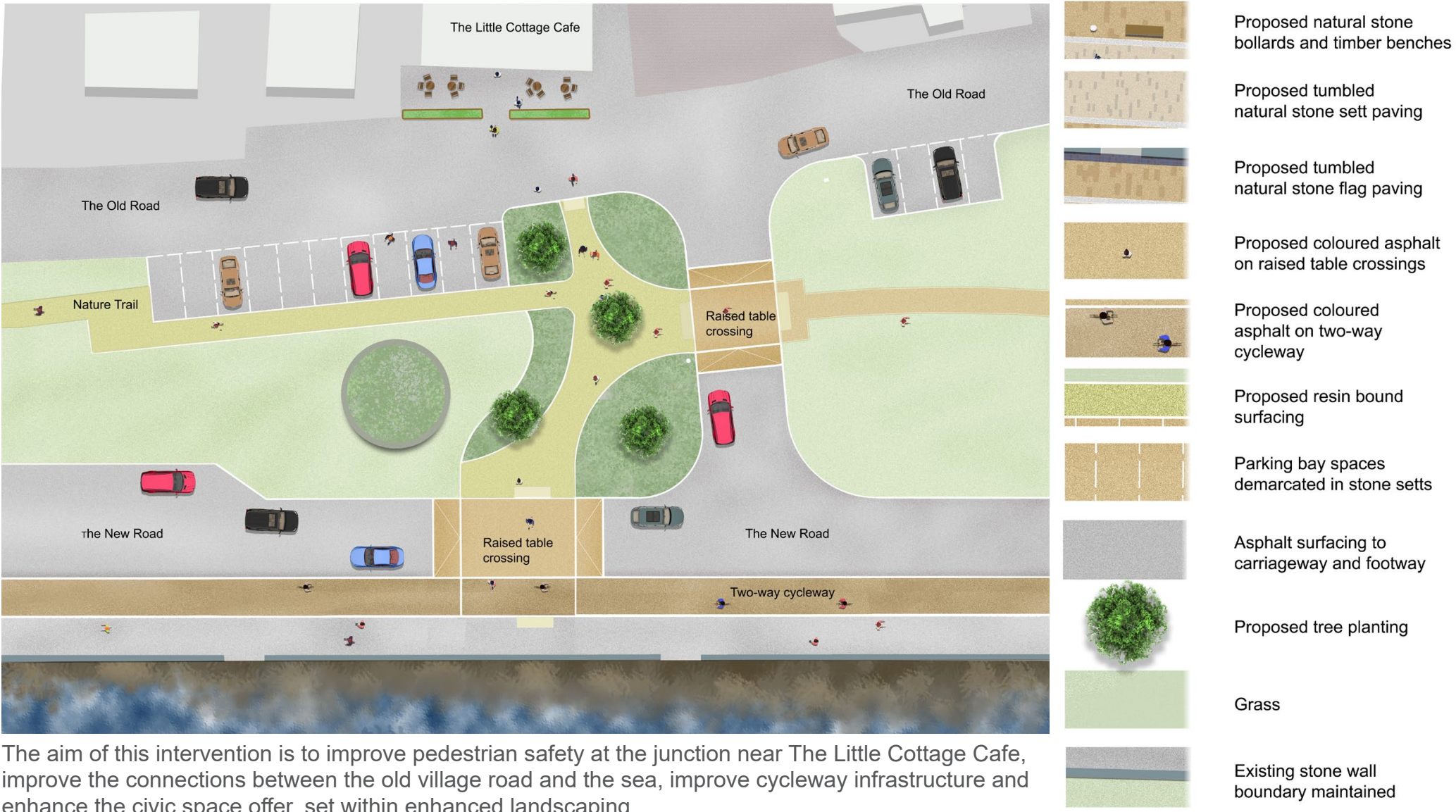

6. Start of the Promenade / Entrance to the Village

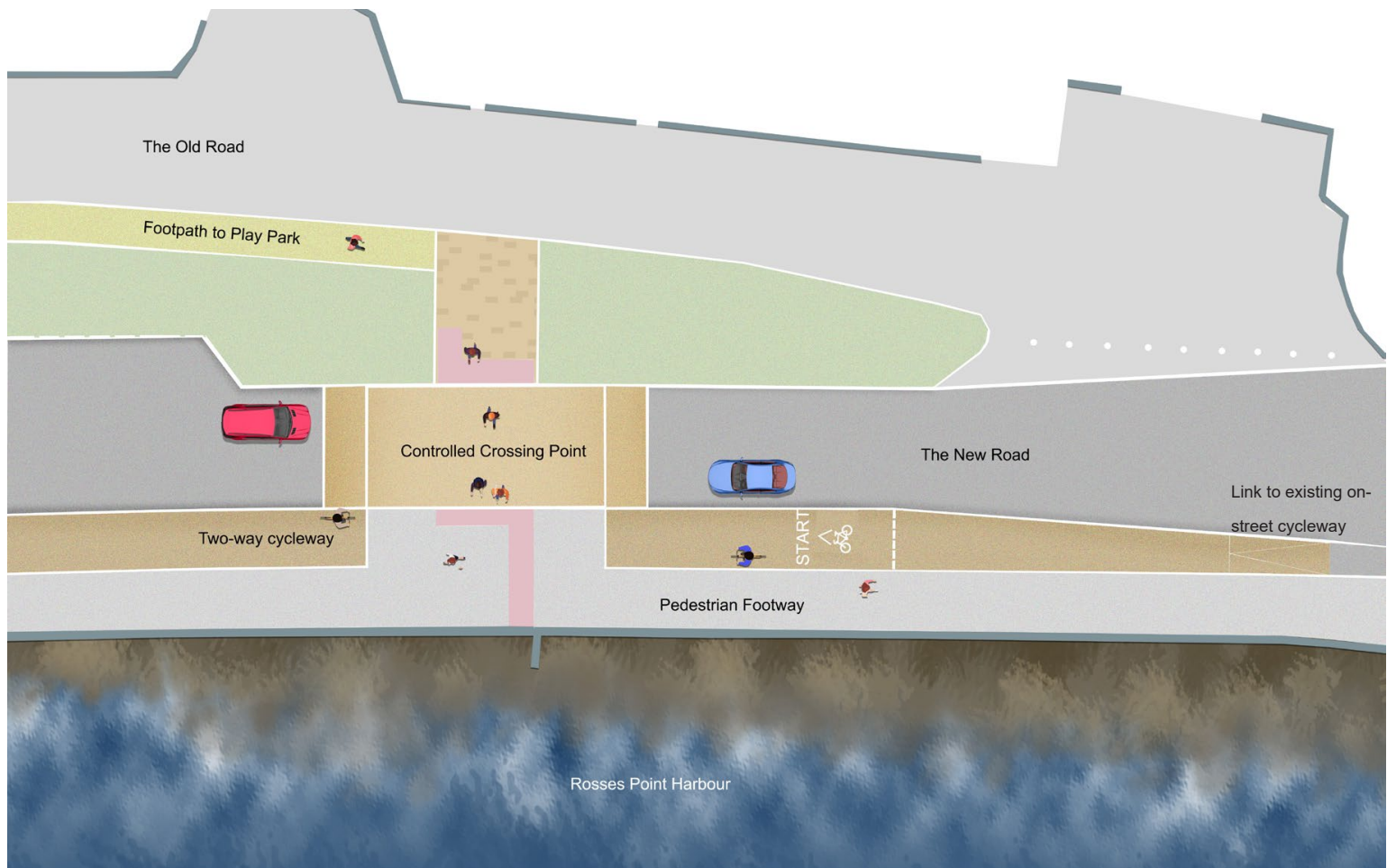

Rosses Point Public Realm Enhancement Project

The Old Village Road - before and after



Area outside Driftwood - existing



Area outside Driftwood - re-imagined



This project is being funded by the Department of Rural and Community Development through the Rural Regeneration and Development Fund.

Rosses Point Public Realm Enhancement Project

The Old Village Road - before and after



Area outside Harry's Bar - existing



Area outside Harry's Bar - re-imagined



This project is being funded by the Department of Rural and Community Development through the Rural Regeneration and Development Fund.